

SOLID BAIL WEDGE CLAMP

Product Details

- Service Wedge Clamps are used for low-tension dead-ending of ACSR, AAAC, and Aluminum Conductors.
- Wedge Clamps shells have a pre-applied gritted electrical joint compound to strengthen hold on conductor.
- Allied Bolt Wedge Clamps feature a notch in the bail wire to prevent the bail from disassembling after installation.
- All Wedge Clamps are formed from high-strength T2024 Aluminum.
- Bail wire is 6-1/2" long and is formed from Type 304 Stainless Steel.

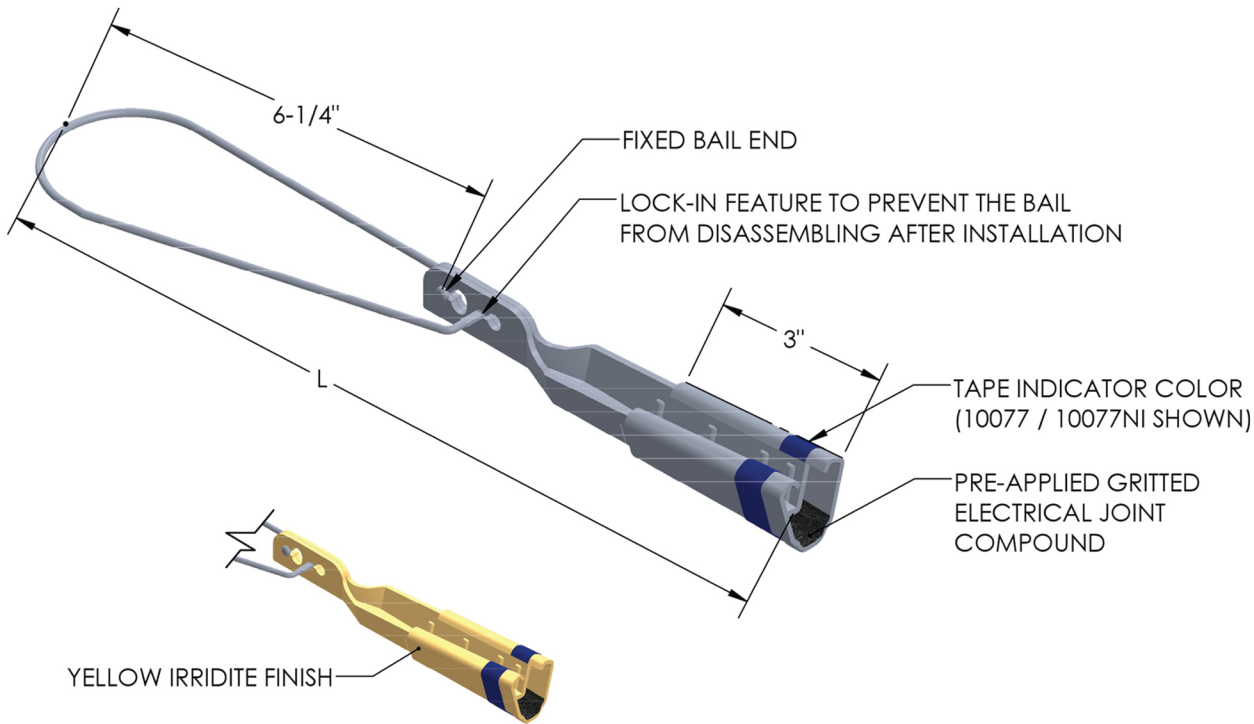

Specifications

Part #	Description	CONDUCTOR SIZE		DIA. RANGE	ULIMATE STRENGTH	TAPES INDICATOR COLOR	L	WEDGE AND SHELL MATERIAL	BAIL MATERIAL
		ACSR AAAC	ALU CONDUCTOR						
10076 10076NI	Small (#2-6) Wedge Clamp W/ Irridite Small (#2-6) Wedge Clamp W/ Non-Irridite	2-6	1 STR-6 SOL	.160"-.330"	1100 LBS.	ORANGE	10-1/2"	T2024 Alimunnunm	304 Stainless Steel
10077 10077NI	Medium (1/0-#4) Wedge Clamp w/ Irridite Medium (1/0-#4) Wedge Clamp W/ Non-Irridite	4-1/0	2/0 STR-2 SOL	.230"-.420"	1200 LBS.	BLUE	12-3/4"		
10078 10078NI	Large (4/0-2/0) Wedge Clamp w/ Irridite Large (4/0-2/0) Wedge Clamp W/ Non-Irridite	4/0-2/0	4/0 STR-2/0 SOL	.400"-.563"	1600 LBS.	RED	13"		



For technical assistance, sample, or quote
Please call us at (516)512-7600 or email us at orders@alliedboltinc.com

Fax: (516)512-7611 www.alliedboltinc.com

SOLID BAIL WEDGE CLAMP

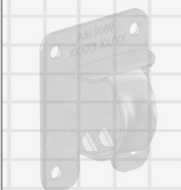
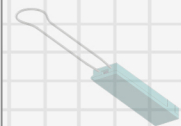
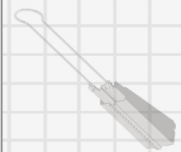
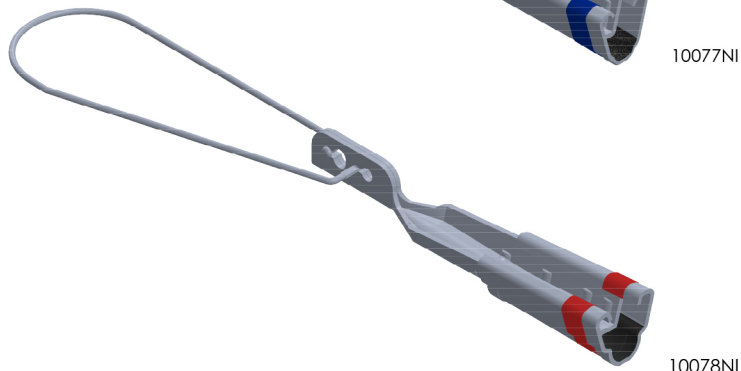
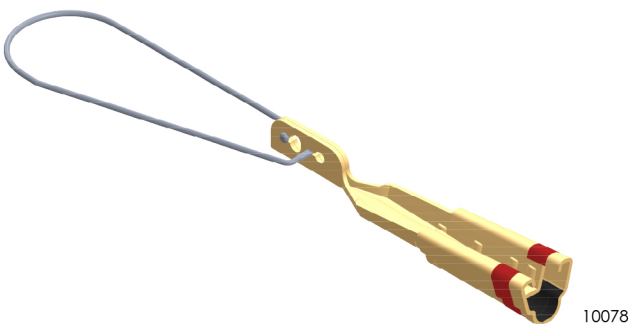
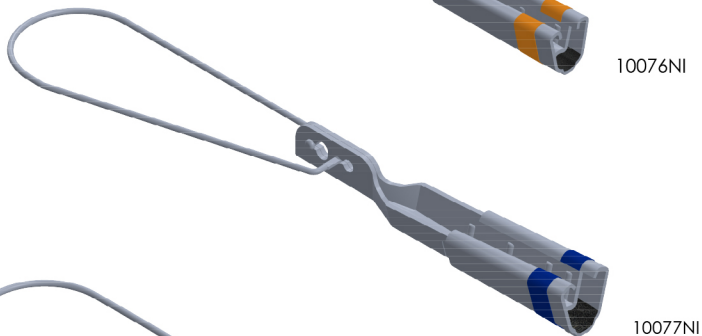
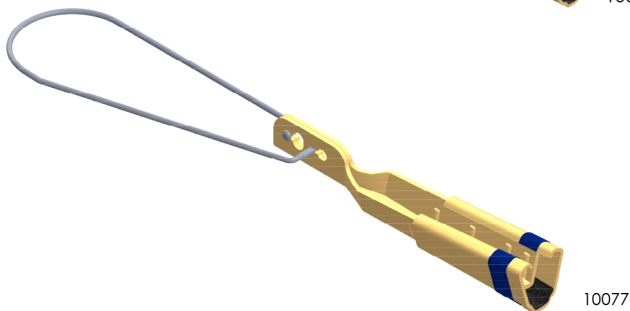
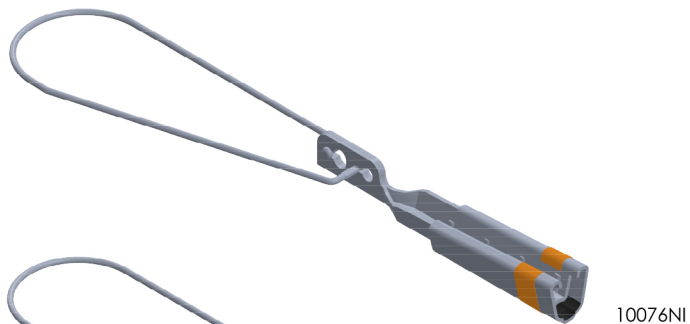
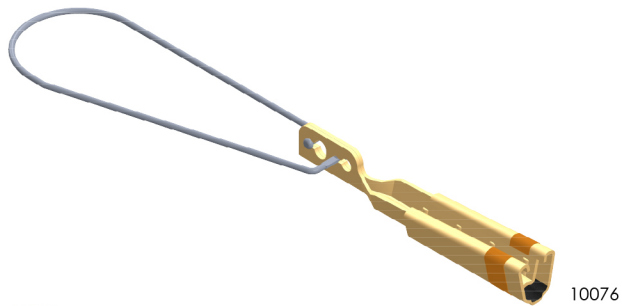

Part #	Package Quantity	Package Per Carton	Carton Weight
10076	100	1	15 lbs.
10077	50	1	13 lbs.
10078	50	1	14 lbs.
10076NI	100	1	15 lbs.
10077NI	50	1	14 lbs.
10078NI	50	1	14 lbs.

For technical assistance, sample, or quote
 Please call us at (516)512-7600 or email us at orders@alliedboltinc.com

Fax: (516)512-7611 www.alliedboltinc.com